



Standard floor loading is 3kN/m². Any loading imposed on a floor that is greater than 3kN/m² may require strengthening. Please contact your hire centre if you expect to exceed 3kN/m².

Please note that this and any accompanying drawing(s) are for illustrative purposes only and as such, the building shown may vary from the actual finished building on site.

The position of windows, external doors and electrical fixtures (if shown) are dependent on stock availability at time of order.

EXTERNAL COLOUR SCHEME | Ultima

- Walls - Goosewing Grey - nearest BS ref 10 A 05
- Vertical wall trim - Goosewing Grey - nearest BS ref 10 A 05
- Bottom wall trims - White - nearest BS ref 00 E 55
- Long wall fascias - Goosewing Grey - nearest BS ref 10 A 05
- Long wall fascia (covering beam) - White - nearest BS ref 00 E 55
- Short wall composite fascia - Goosewing Grey - nearest BS ref 10 A 05
- Roof - White - nearest BS ref 00 E 55
- External Skirt - Goosewing Grey - nearest BS ref 10 A 05
- Columns, external corners - Grey - BS 4800 00 A 05
- Columns, intermediate - Grey - BS 4800 00 A 05
- Windows - Blue Grey - nearest BS 4800 18 B 29
- Doors (insulated door) - Slate grey - nearest BS 18 B 25

Internal Portakabin Note
For connection details please see drawing DQ0539

Fire exit provision subject to building control/fire officer approval

30 Minute Fire Rated Partition

B	Internal layout amended	11.05.19	BME
A	Added Head Teacher Office, Cleaner's room and Server.	28.05.19	JW
Rev	Revision Description	Date	By
Project Name Tudor Grange Primary School			
Client Name Mott MacDonald			
Sheet Name Proposed Layout - 7 x UK123 Ultima Modules & PL051 Portaloo Unit			
Date	Scale		
21.05.2019	1 : 100 @ A3		
Drawing Number	Rev.	Drawn by	
HD/7233/03	B	BME	

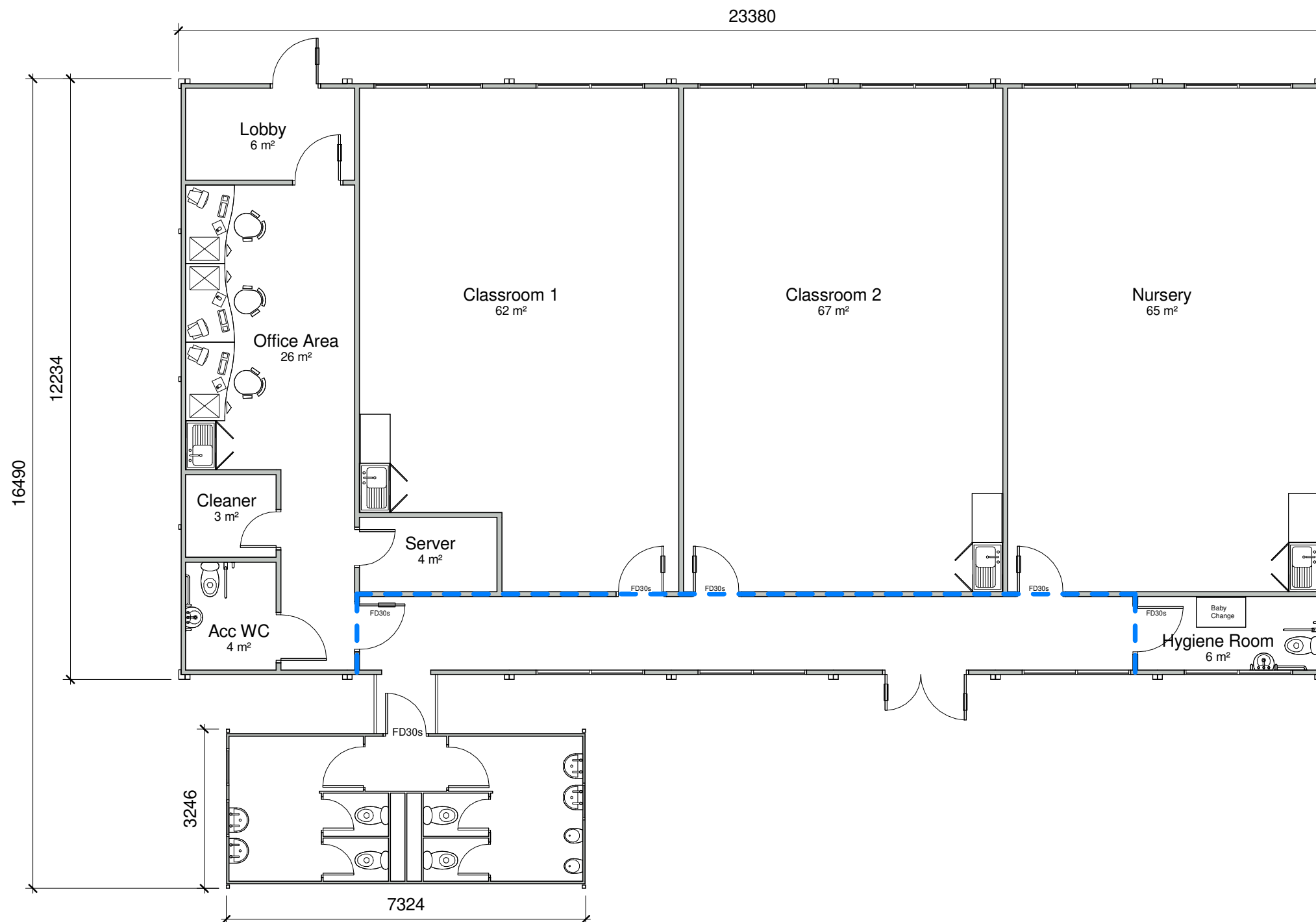

1 Proposed Layout
1 : 100

Total Floor Area - 295 sq.m

Please note - fire exit provision and fire ratings are subject to Building Control / Fire Officer approval